

This document, together with the concepts and designs presented herein, as an instrument of service, is intended only for the specific purpose and client for which it was prepared. Reuse of and improper reliance on this document without written authorization and adaptation by Kinley-Horn and Associates, Inc. shall be without liability to Kinley-Horn and Associates, Inc.

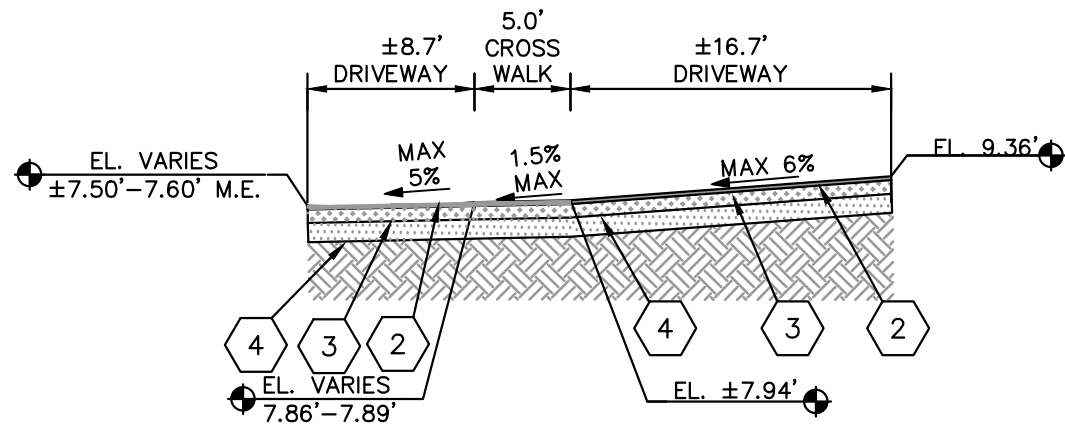

SECTION A-A

SCALE: N.T.S.

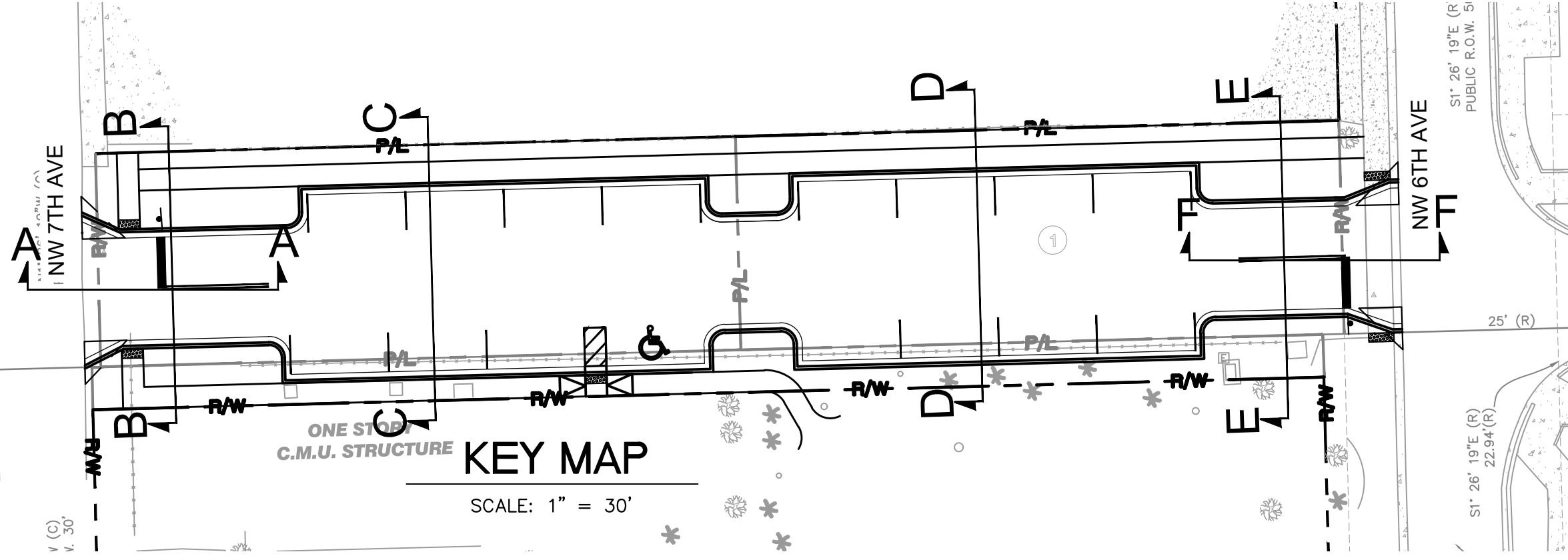
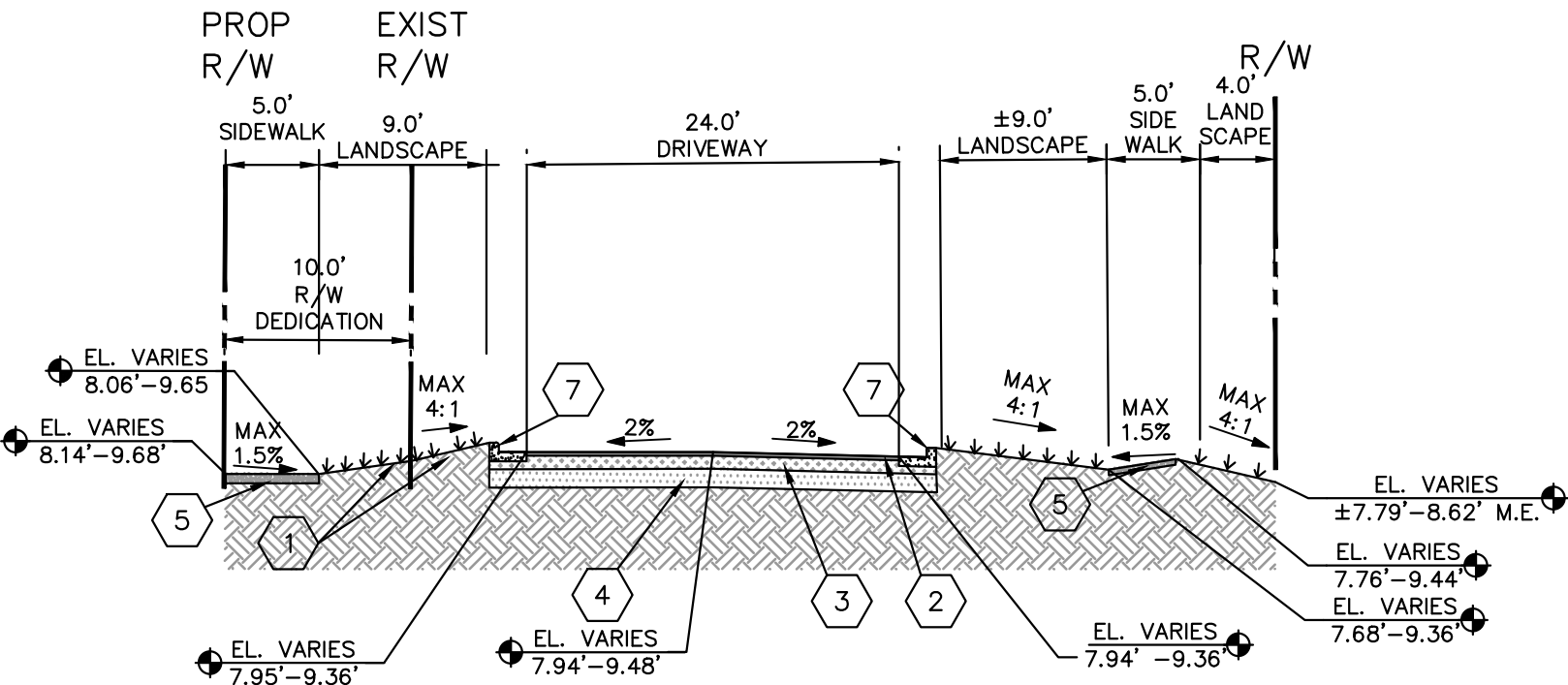

SECTION B-E

SCALE: N.T.S.

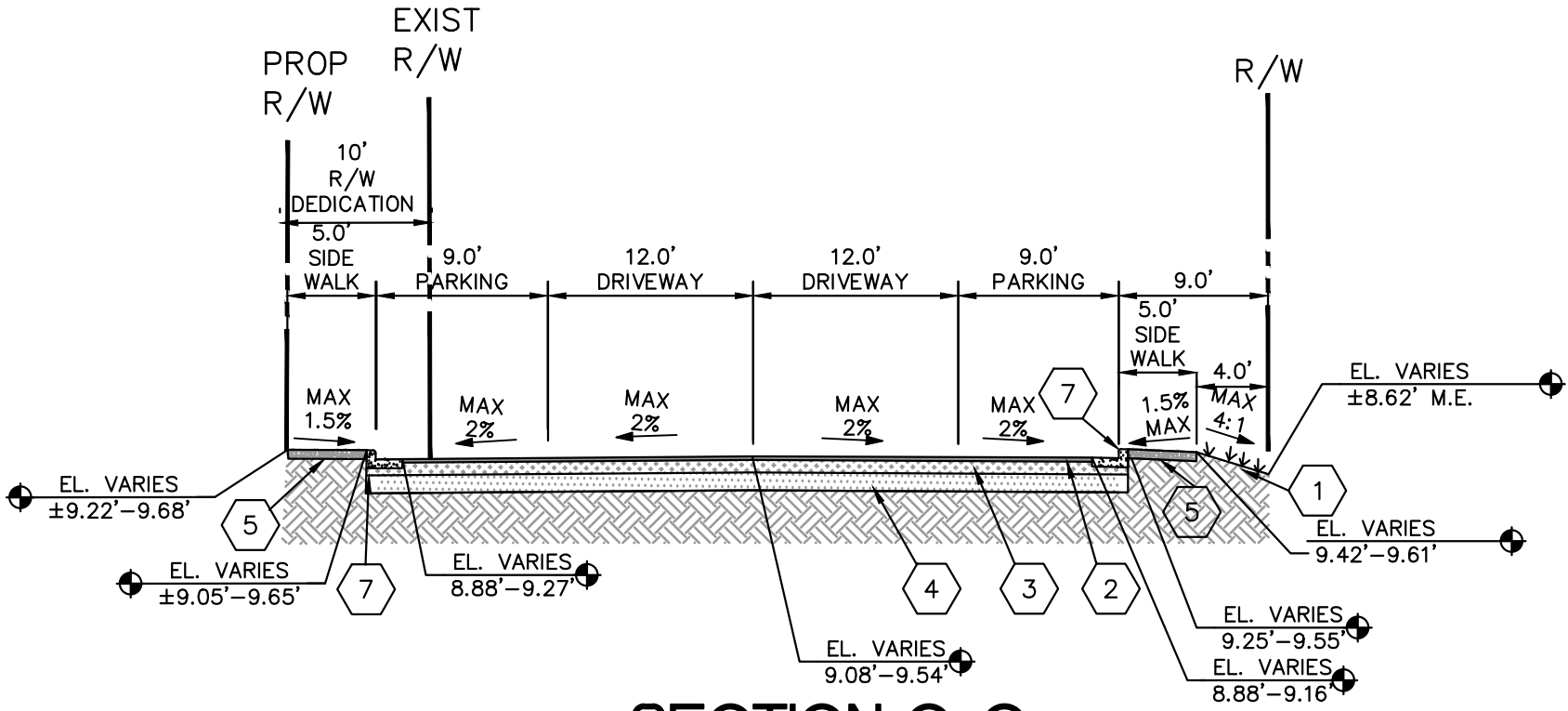

SECTION C-6

SCALE: N.T.S.

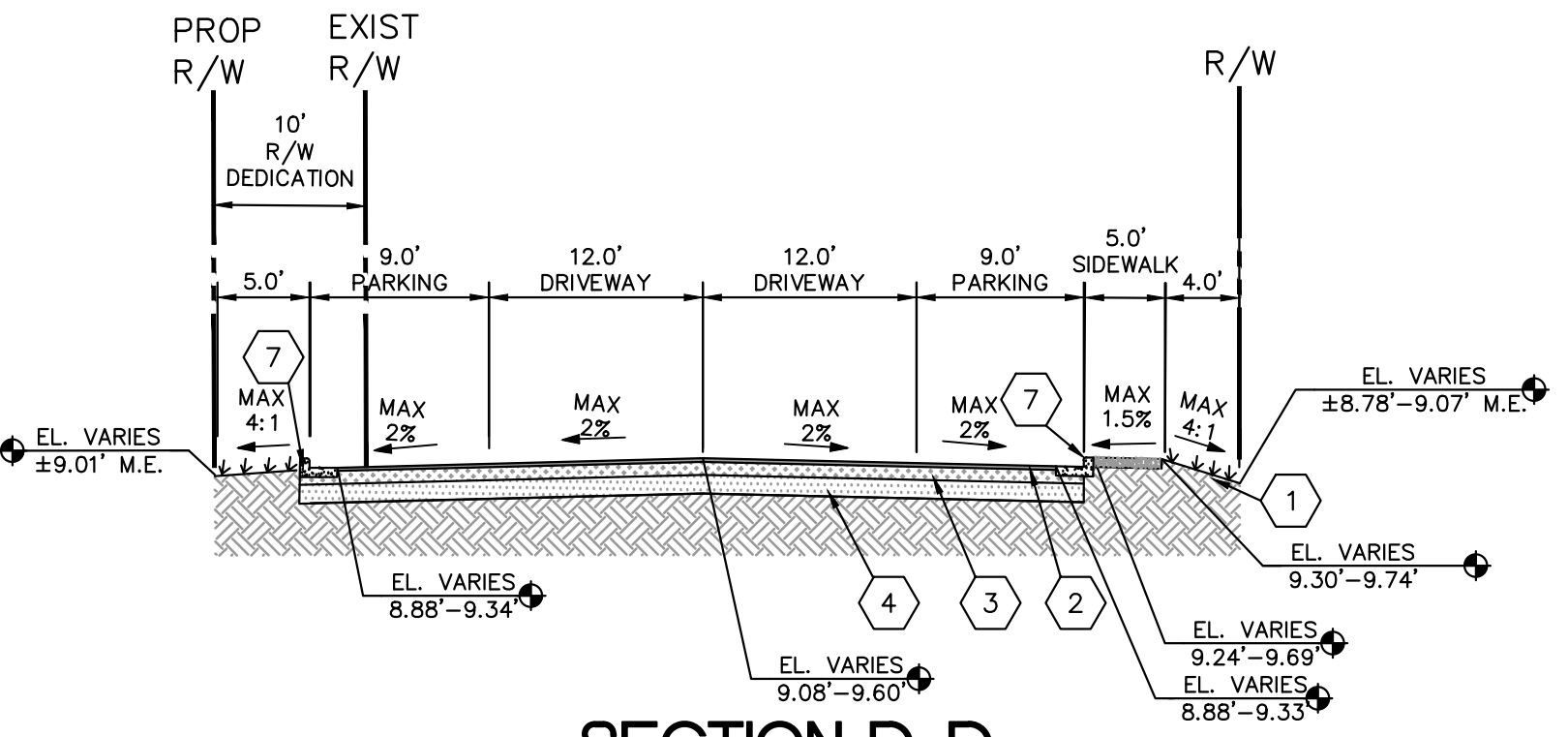

SECTION D-D  
SCALE: N.T.S.

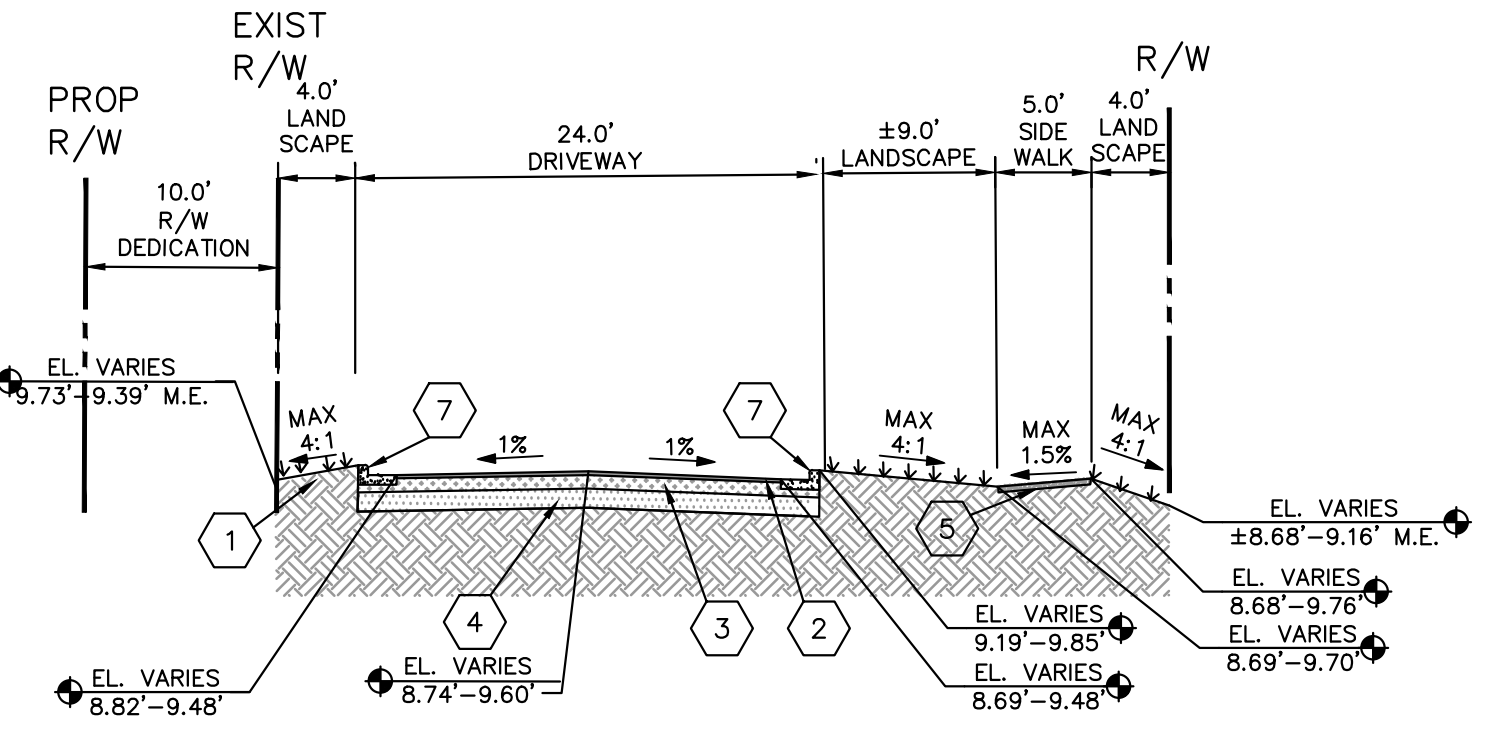

SECTION E-E  
SCALE: N.T.S.

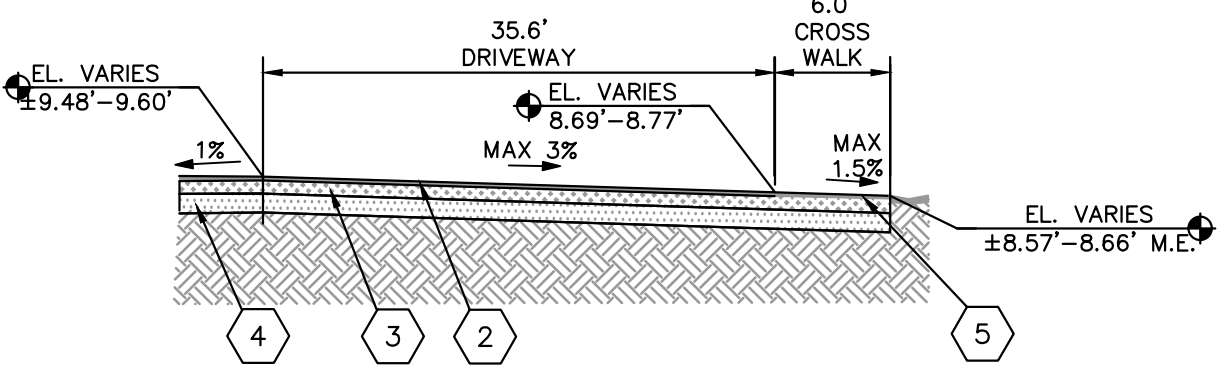

**SECTION F-1**  
SCALE: N.T.S.

- ## PAVING LEGEND

- 1) LANDSCAPE AREA (SEE LANDSCAPING PLANS FOR DETAILS)
- 2) 2" ASPHALT SURFACE TYPE SP-12.5 PER FDOT SPECS
- 3) 8" LIMEROCK BASE COMPACTED IN TWO LIFTS AT LEAST 98% (AASHTO T-180) WITH MINIMUM LBR OF 100 (PER CITY OF POMPANO BEACH DETAIL 305-1)
- 4) 12" STABILIZED SUBGRADE (MIN. LBR 40) (COMPACTED TO 98% MAX. DRY DENSITY ASTM D 1557) (PER CITY OF POMPANO BEACH DETAIL 305-1)
- 5) 4" THICK CONCRETE, MIN. 3000 PSI (PER CITY OF POMPANO BEACH DETAIL 301-1, 301-2, AND 306-1)
- 6) TYPE "D" CURB (PER CITY OF POMPANO BEACH DETAIL 300-2)
- 7) TYPE "F" CURB & GUTTER (PER CITY OF POMPANO BEACH DETAIL 300-1)

**Kimley»»Horn**

© 2024 KIMLEY-HORN AND ASSOCIATES, INC.  
3201 PETERS ROAD, SUITE 2200, PLANTATION, FL 33324  
PHONE: 954-535-5100 FAX: 954-739-2247  
WWW.KIMLEY-HORN.COM REGISTRY No. 696

LICENSED PROFESSIONAL

ERESA VILLALON  
CAMACHO, P.E.

4893

ATE:

KHA PROJECT

DATE \_\_\_\_\_

JULY 2025

SCALE AS SHOWN

1500

\_\_\_\_\_  
CHECKED BY

## CROSS SECTIONS

**HANNIE ADDERLY GILLIS  
PARKING LOT  
PREPARED FOR**

CITY OF POMPANO BEACH  
FL

Teresa Villalon-Camacho State of Florida, Professional Engineer  
License No. 94893

This item has been digitally signed and sealed by Teresa Villalon-Camacho on the date indicated here.

Signature must be verified on any electronic copies

PLANS ARE IN NAVD 1988 DATUM  
CONVERSION EQUATION IS BELOW:  
(NAVD 1988) + 1.57' = (NGVD 1929)

THE PRESENCE OF GROUNDWATER SHOULD BE ANTICIPATED. CONTRACTOR'S BID SHALL INCLUDE CONSIDERATION FOR ADDRESSING THIS ISSUE AND OBTAINING ALL NECESSARY PERMITS

**Always call 811 two full business days before you dig to have underground utilities located and marked.**

**Sunshine811.com**

2000033